

Iso-Sep PM

Sound Control Underlayment

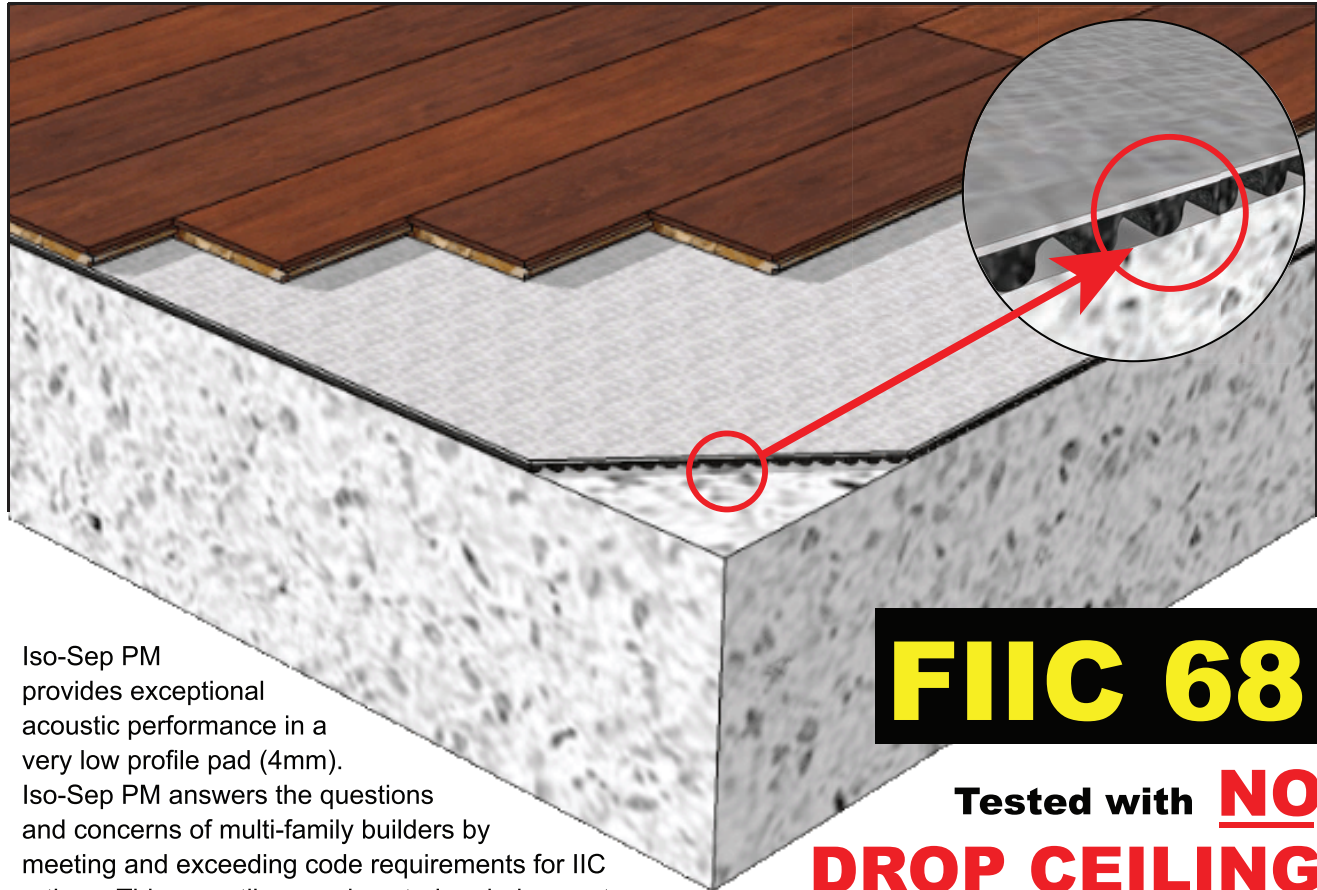

Iso-Sep PM provides exceptional acoustic performance in a very low profile pad (4mm). Iso-Sep PM answers the questions and concerns of multi-family builders by meeting and exceeding code requirements for IIC ratings. This versatile sound control underlayment can be used under gypsum or light weight concrete pours or with select floor finishes applied directly on top saving time and construction costs.

FIIC 68

Tested with **NO**
DROP CEILING

Thin Mat Technology

- Iso-Sep PM is made from rubber which is still the best isolation material known and will not crush out.
- Profiled bottom surface of the pad reduces the floor contact area by a nominal 80% while providing even support for the gypsum pour, or selected finished floor.
- Breaks the sound transmission path through the floor/ceiling assembly and prevents flanking from room-to-room.

Environmentally Friendly & Easy to Install

- Iso-Sep PM is manufactured from 100% recycled rubber bonded with a permanently elastic polyurethane binder.
- Contributes to LEED credits. Green Label Approved.
- Class 1 Fire Rated with a Class 1 rated surface material.
- Scrim facing sheet is reinforced fiberglass. Allows for direct pour over.
- Installs fast - Easy to cut with standard utility knives.
- Iso-Sep-PM lays flat and will not slip or buckle during installation.

Typical Uses

FIIC 68

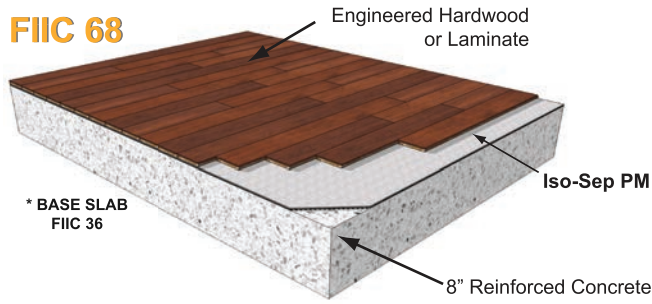

* BASE SLAB
FIIC 36

NO DROP CEILING

IIC 58 STC 54

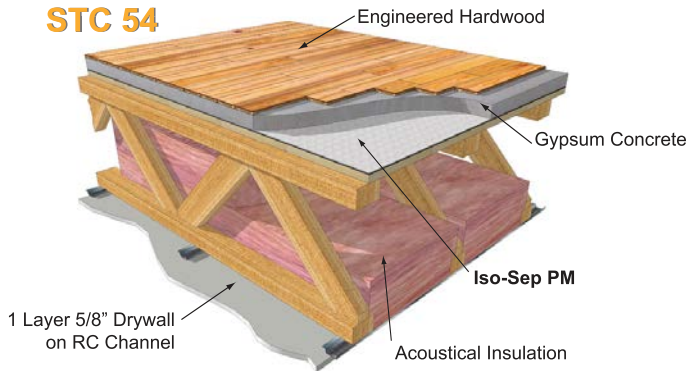

IIC 51 STC 53

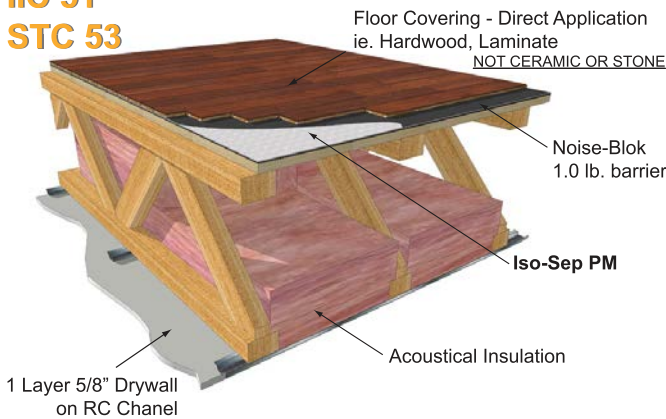

Test Results

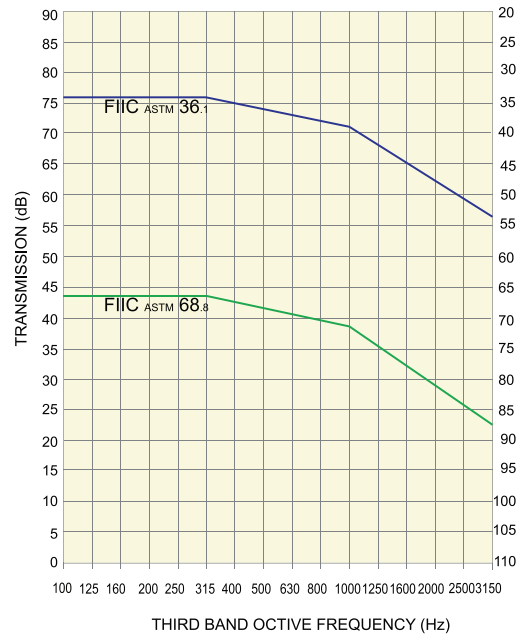
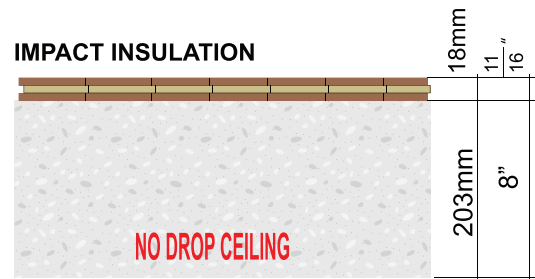

Oak Engineered Hardwood Floor 14mm
ISO-SEP PM

| FIIC ASTM | dB(A) | $\Sigma\Delta$ | n Δ | Δ_{max} |
|-----------|-------|----------------|------------|----------------|
| 68 | 52.6 | 28.8 | 5 | 8.0 |

Concrete Slab

| FIIC ASTM | dB(A) | $\Sigma\Delta$ | n Δ | Δ_{max} |
|-----------|-------|----------------|------------|----------------|
| 36 | 78.6 | 13.3 | 3 | 8.0 |

Technical Specifications

Weight: 60 lbs. / 27.27 Kg.

Thickness: 4mm NOM.

Available in Rolls:

54" x 60' (270 sq.ft.) 60 lbs. each.

Also available to meet yield requirements.

54" x 20' (90 sq.ft.) - 20 lbs. each.

54" x 40' (180 sq.ft.) - 40 lbs. each.

ASTM E 1009-97 — Standard Test Method for Field

Measurement of Tapping Machine Impact Sound Transfer

Through Floor-Ceiling Assemblies and Associated Support

Structures

ASTM E 989-89 (reapproved 1994) — Standard Classification

for Determination of Impact Insulation Class (IIC)